

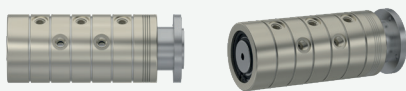

Multiports M2-A5



Multi-passage rotary unions.

 Media Type
Hydraulic Oil, Air - Vacuum









 Max. Speed
250 RPM

 Max. Pressure
250 BAR

 Max. Temperature
80 °C

 Connection Type
NPT, BSPP, BSPT

 Rotor Size
2 x 1/4" - 12 x 3/4"

-  Multi flow design
-  Self supported sealing
-  Dynamic carbon teflon sealing
-  Special design sealing part for different fluids
-  Flanged shaft
-  Chrom plated sealing surface
-  Aluminium steel body
-  Anti corrosion plated
-  Custom connections types are available

 Do not operate without fluid.

DIMENSIONS

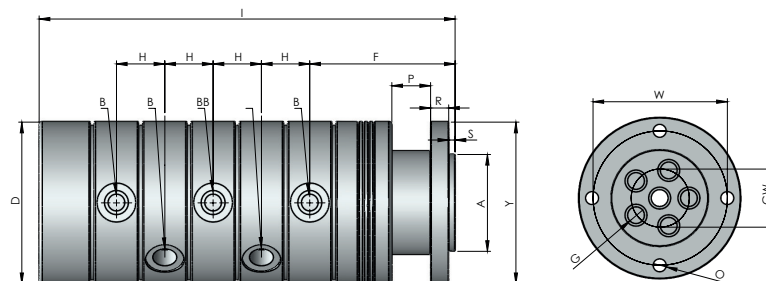

SIZE	MODEL NO	B	Y Ø	A Ø	G Ø	D Ø	F	H	I	S	P	R	W	GW	O	KG
5 X 1/4"	M2-35081-200	1/4" NPT	81	45	7	80	71	23,40	207,70	3	20	7	70	20	6,5	3,5
5 X 1/4"	M2-35082-200	1/4" BSP	81	45	7	80	71	23,40	207,70	3	20	7	70	20	6,5	3,5
5 X 1/4"	M2-35083-200	1/4" BSPP	81	45	7	80	71	23,40	207,70	3	20	7	70	20	6,5	3,5
5 X 3/8"	M2-35101-200	3/8" NPT	108	65	10	108	89	30	253	3	20	10	90	28	9	8
5 X 3/8"	M2-35102-200	3/8" BSP	108	65	10	108	89	30	253	3	20	10	90	28	9	8
5 X 3/8"	M2-35103-200	3/8" BSPP	108	65	10	180	89	30	253	3	20	10	90	28	9	8
5 X 1/2"	M2-35151-200	1/2" NPT	125	75	13	125	112,50	37,40	322	5	30	14	104	45	10	14,95
5 X 1/2"	M2-35152-200	1/2" BSP	125	75	13	125	112,50	37,40	322	5	30	14	104	45	10	14,95
5 X 1/2"	M2-35153-200	1/2" BSPP	125	75	13	125	112,50	37,40	322	5	30	14	104	45	10	14,95
5 X 3/4"	M2-35201-200	3/4" NPT	165	115	18	165	132,50	43,40	373,70	5	45	13	139	60	11	29,50
5 X 3/4"	M2-35202-200	3/4" BSP	165	115	18	165	132,50	43,40	373,70	5	45	13	139	60	11	29,50
5 X 3/4"	M2-35203-200	3/4" BSPP	165	115	18	165	132,50	43,40	373,70	5	45	13	139	60	11	29,50